

- Montageanleitung
- Assembly instructions
- Notice de montage
- Montagehandleiding
- Návod na montáž
- Instrucțiune de montaj
- Navodila za namestitev
- Installationstruktioneer

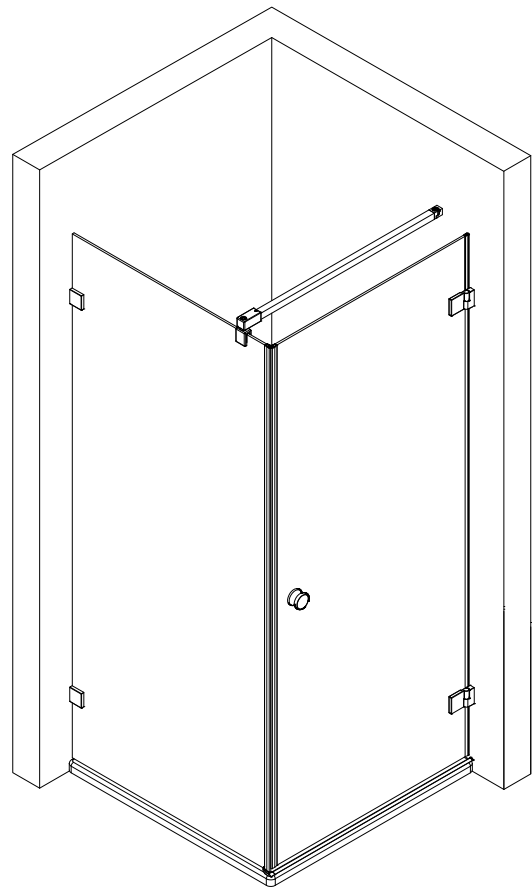

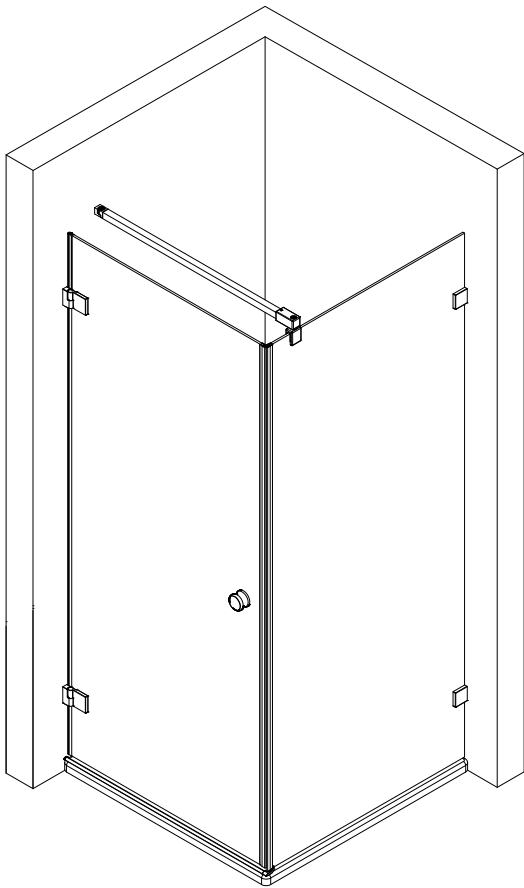
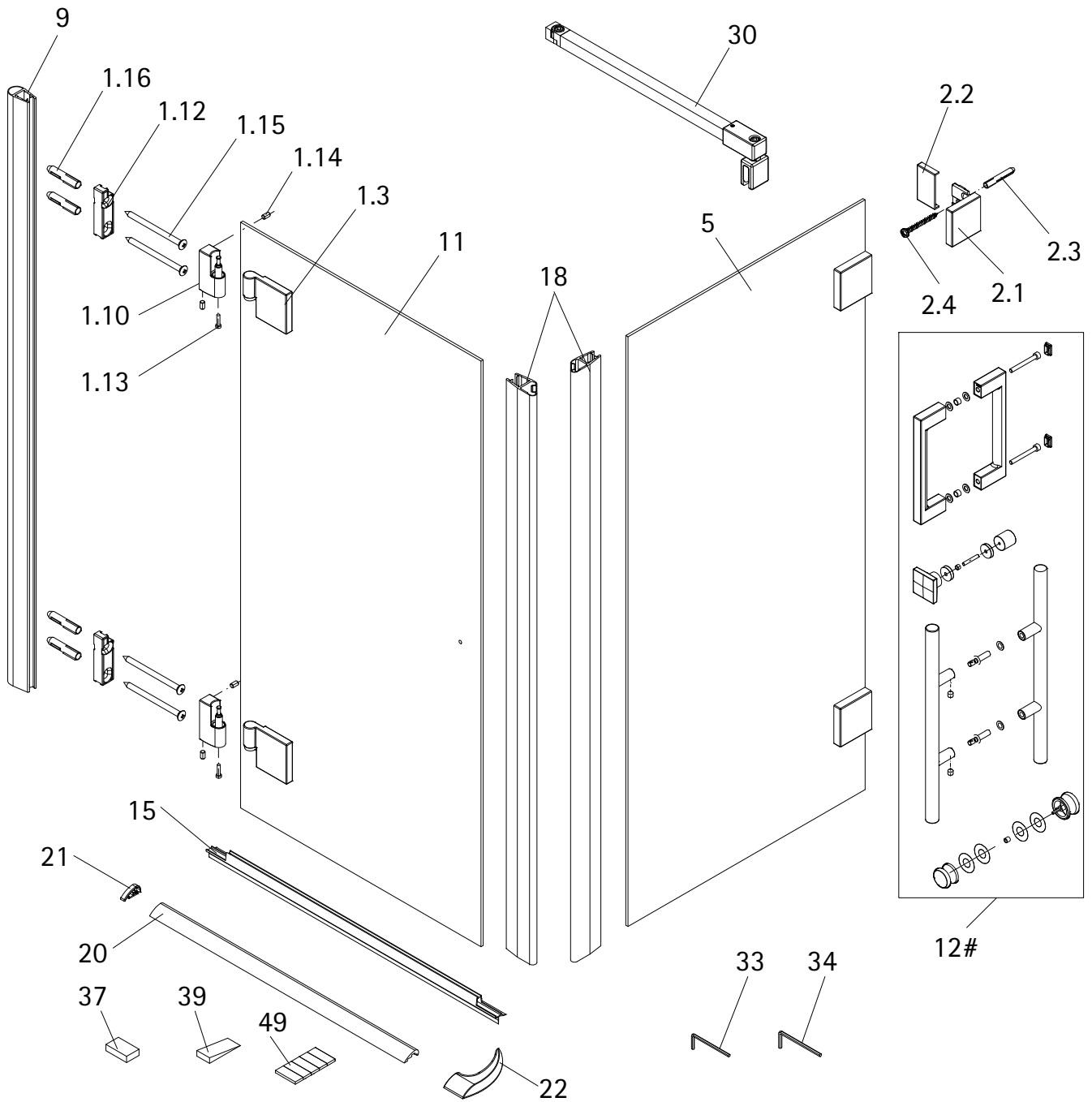

Pos.	Bezeichnung	Ersatzteil-Nr.	Preis
1	2x Scharnier komplett eckig	E 77291	Stück 95,00 €
1.3	2x Scharnier Türteil		
1.10	2x Wandanschlusscharnier		
1.12	2x Wandflansch		
1.13	2x Zylinderschraube M4 x 16 mm		
1.14	4x Gewindestift M6 x 10 mm		
1.15	4x Linsenschraube 4,8 x 60 mm		
1.16	4x Dübel Tri 8/51		
2	2x Winkel Glas Wand komplett		
2.1	2x Winkel		
2.2	2x Blende		
2.3	2x Dübel Tri 8/51		
2.4	2x Linsen-Blechschaube 4,8 x 60 mm		
5	1x Seitenwand rechts/links	E 77073	19,95 €
9	1x O-Dichtung vertikal		
11	1x Tür rechts/links		

Pos.	Bezeichnung	Ersatzteil-Nr.	Preis
12 #	1x Griff komplett		
	Knopfgriff eckig	E 77140-9	Stück 29,95 €
	Stangengriff eckig	E 77140-59	Stück 79,95 €
	Knopfgriff rund	E 77140-1	Stück 29,95 €
	Stangengriff	E 77140-6	Stück 79,95 €
15	1x Wasserabweisprofil	E 77058	34,95 €
18	2x Magnetprofil 45°	E 77055	Paar 49,95 €
20	1x Wasserleiste (inkl. Pos. 21, 22, 49)	E 77050	34,95 €
30	1x Seitenwandabstützung	E 77340	59,00 €
33	1x Innensechskantschlüssel SW 2,5		
34	1x Innensechskantschlüssel SW 3		
37	2x Montagehilfe	E 77201	Set 7,50 €
39	4x Silikonkeil (6 Stk.)	E 77203	Set 13,95 €
49	1x Klebestreifen		

optional

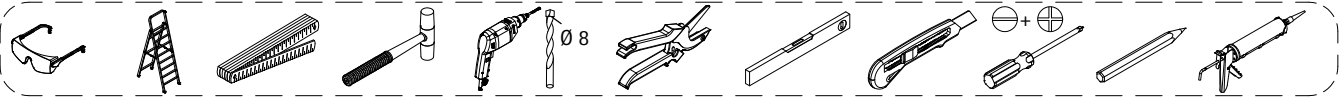
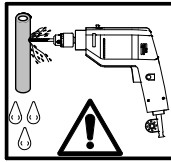
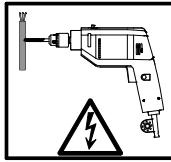
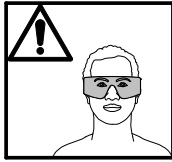
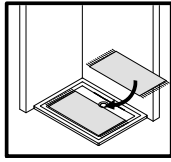
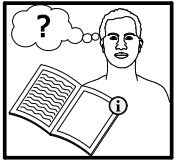

1

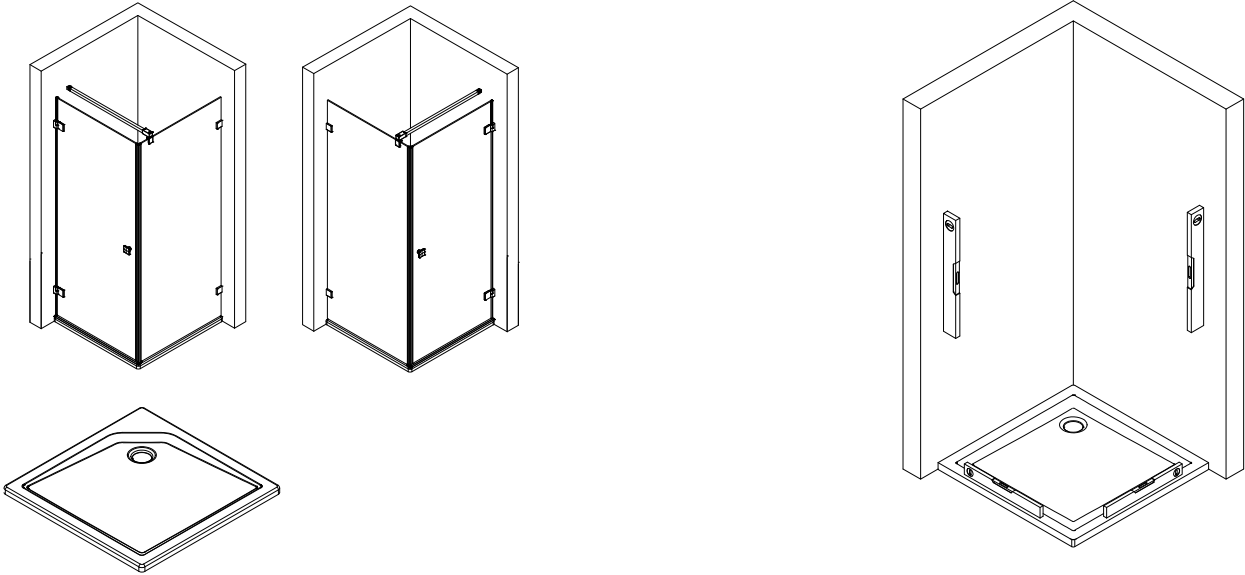

2

Bohrabstände für Wandflansch
bitte aus dem Auftrag entnehmen

Pleas gather distances of the
drillings for wall flange from the
order

Veulliez trouvez les dimensions
pour la distance entre le perçage
pour le bride dans la commande

boorafstanden voor muurflens
s.v.p. uit opdracht nemen

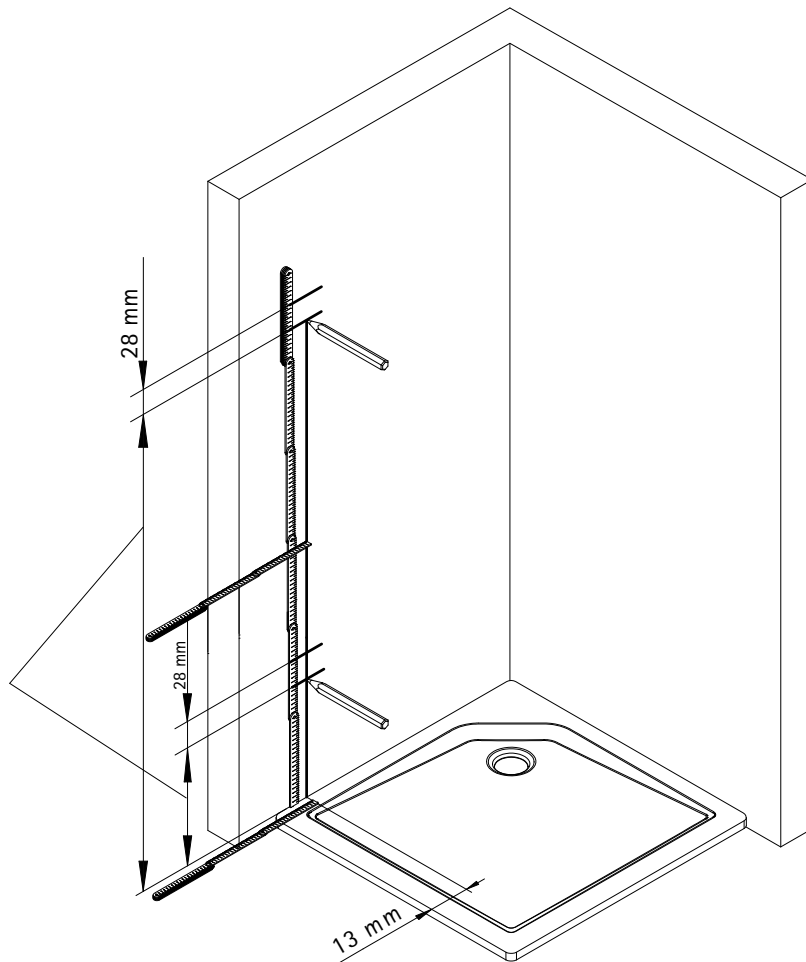

2a

Optional

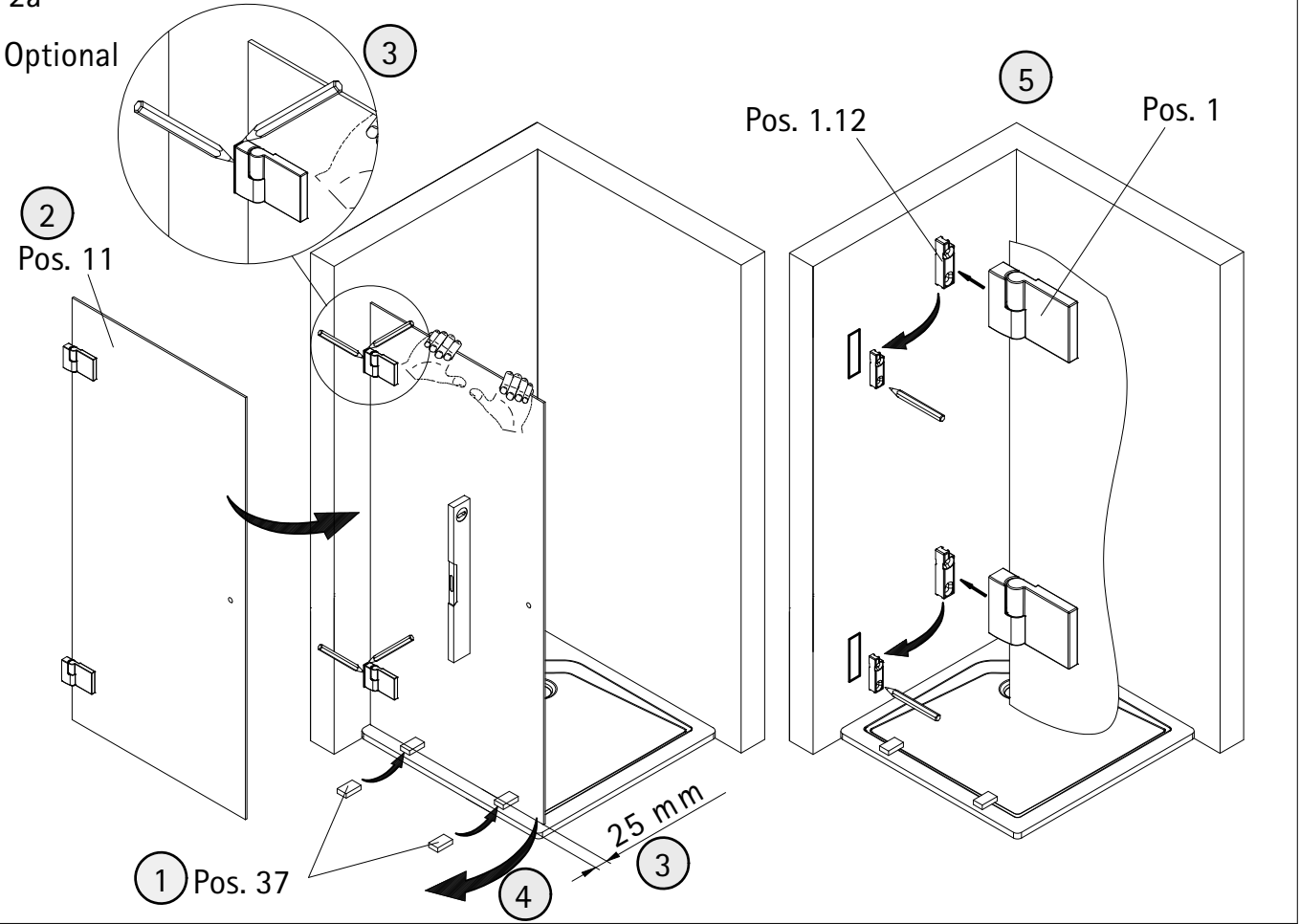

3

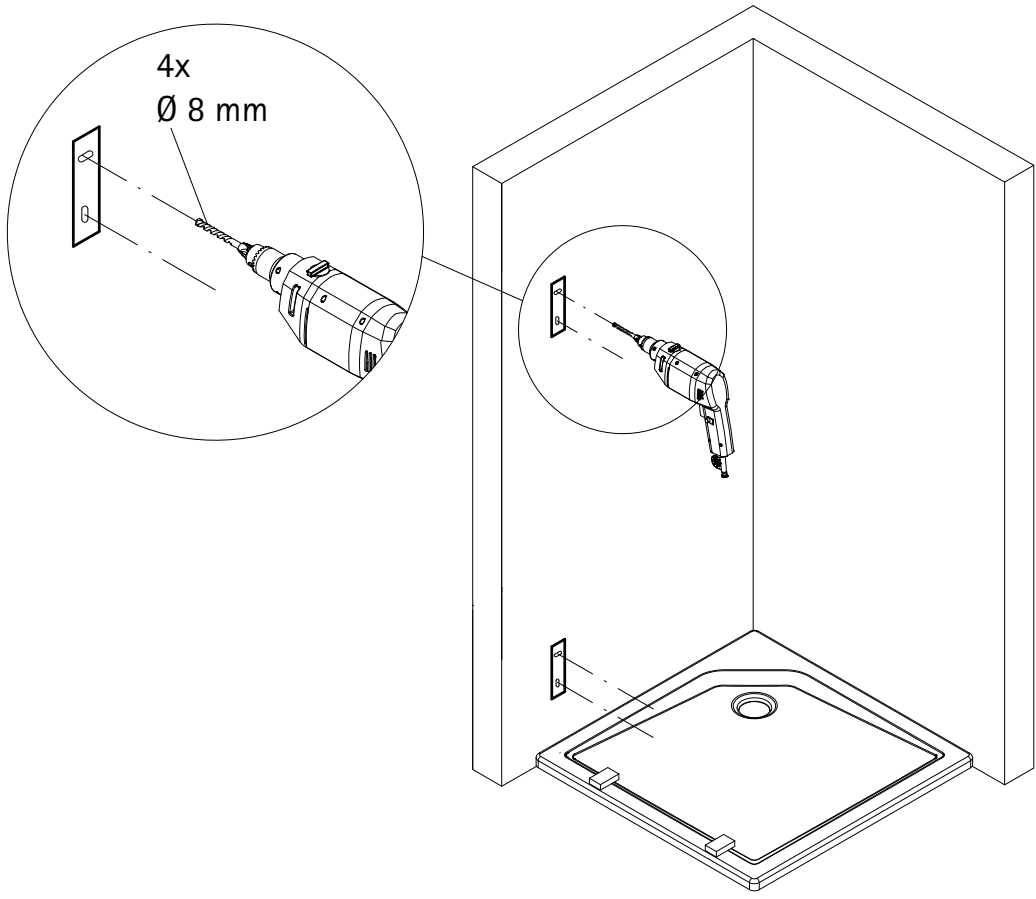

4

1

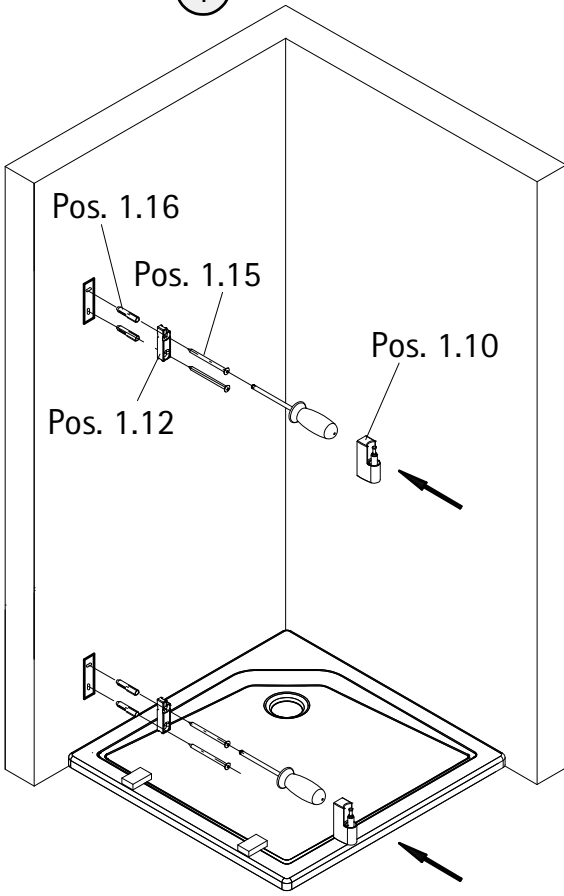

2

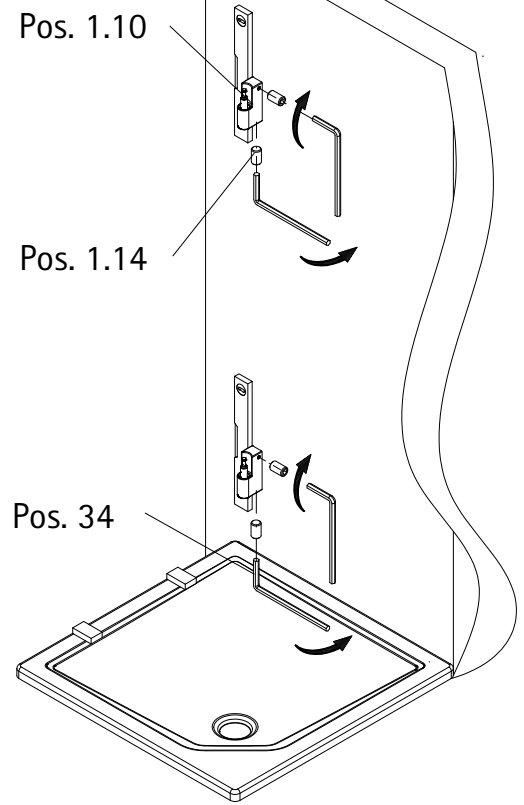

5

1

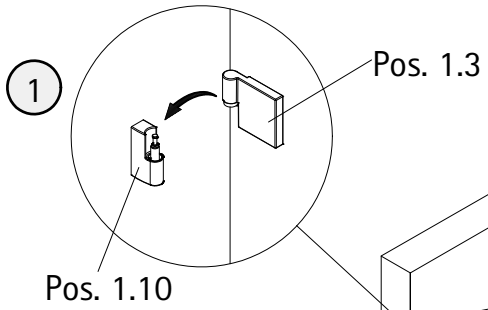

2

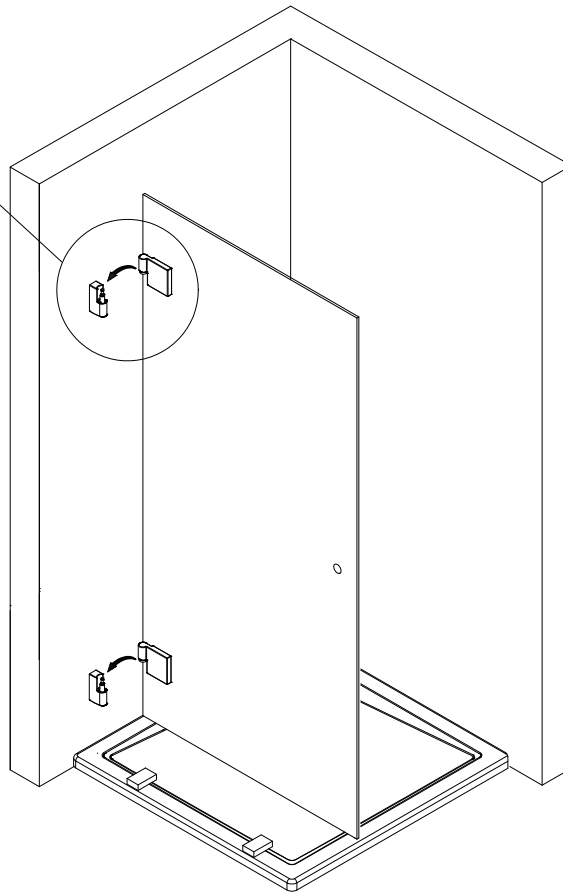
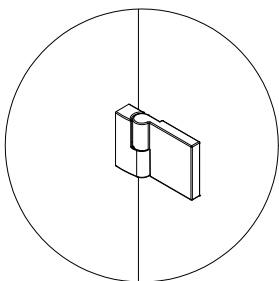

6

1

Wenn ein Luftspalt entsteht Pos. 1.14 lösen
When a gap appears, please loose Pos. 1.14
Quand vous avez un entrefer de tête veuillez
débloquer Pos. 1.14
Als een spleet zichtbaar is s.v.p. pos. 1.14 losmaken

2

Pos. 1.14

Pos. 34

3

4

0

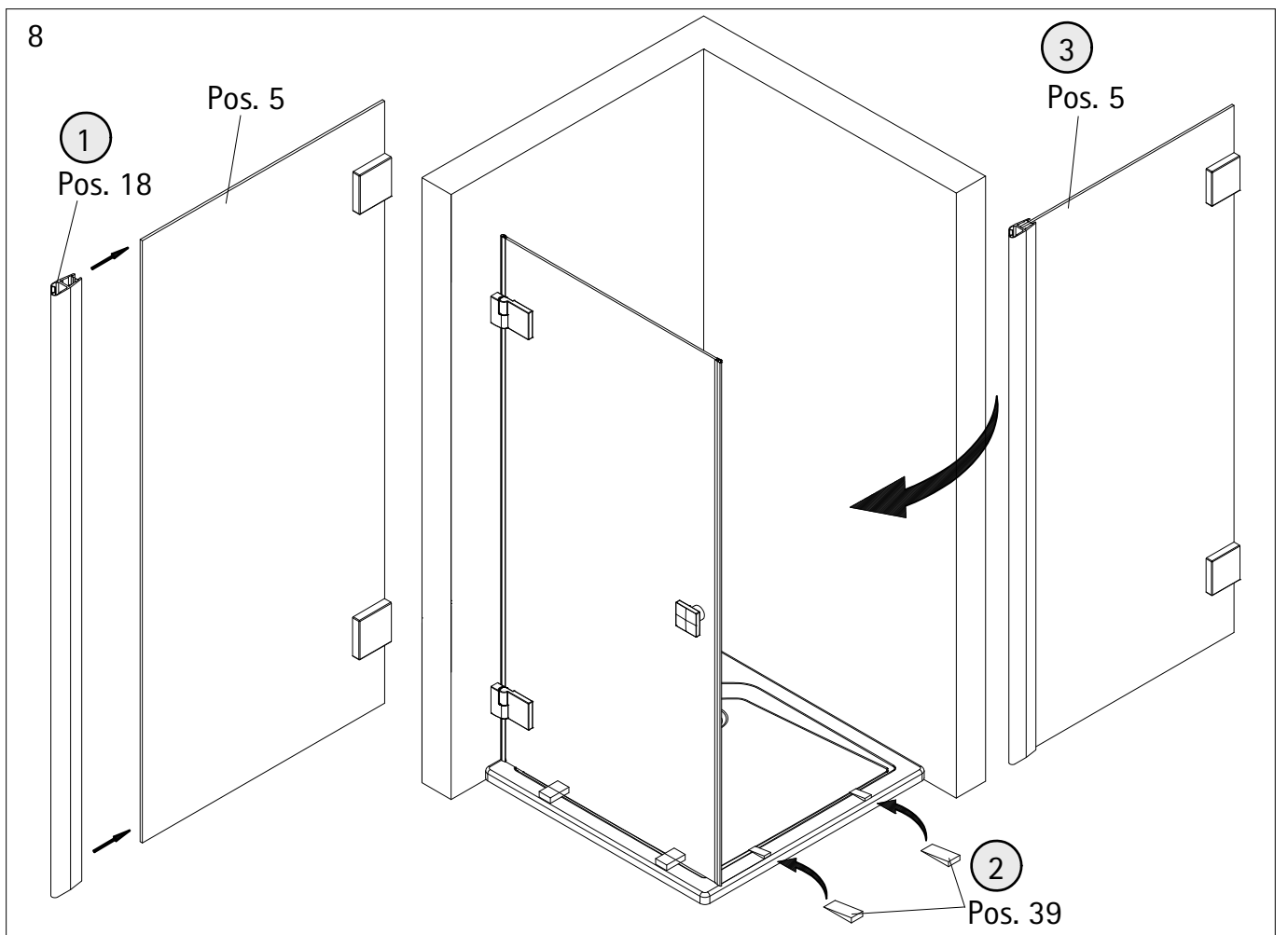
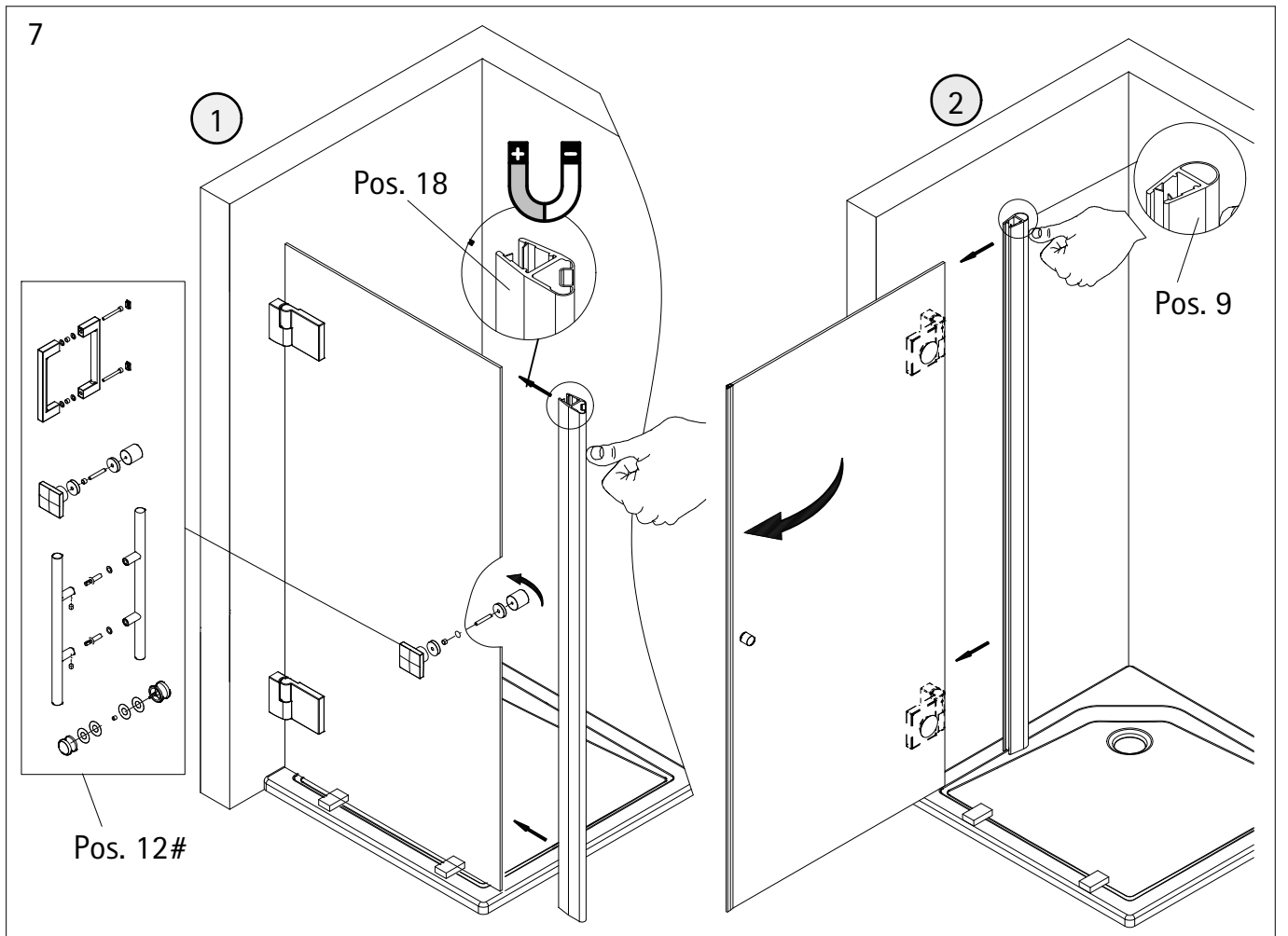

9

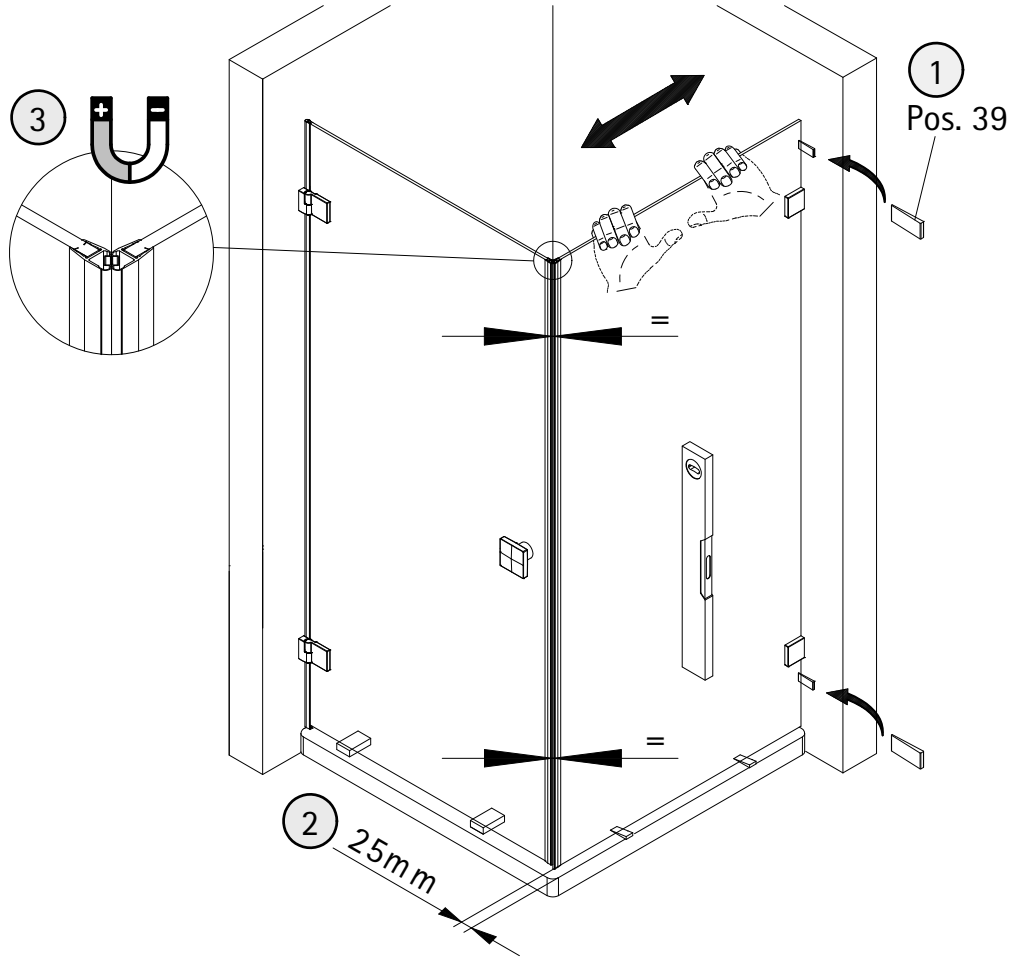

10

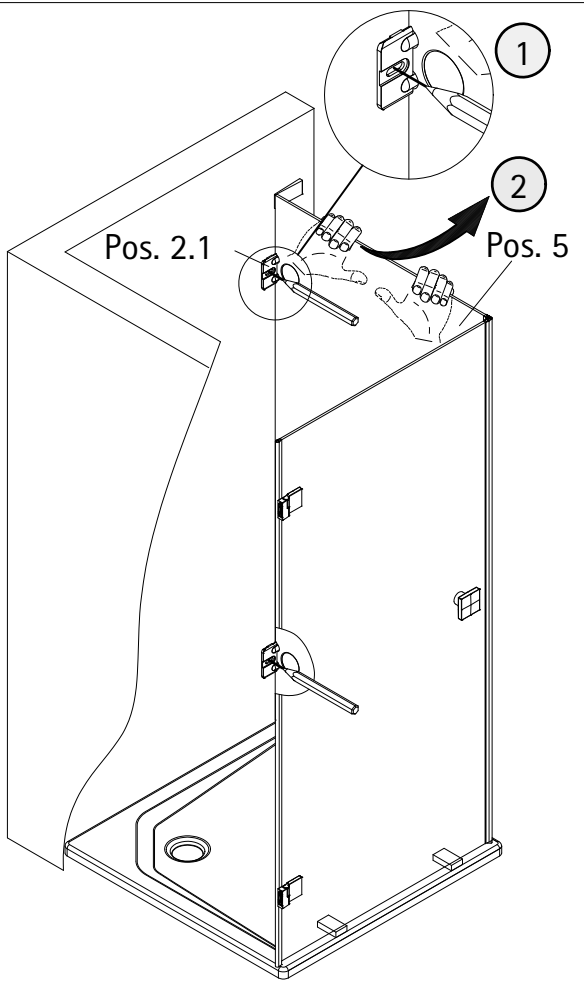

11

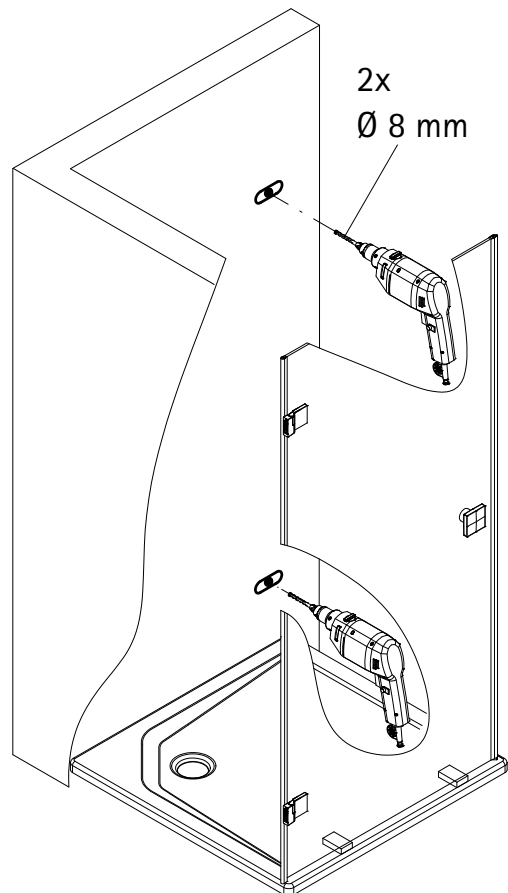

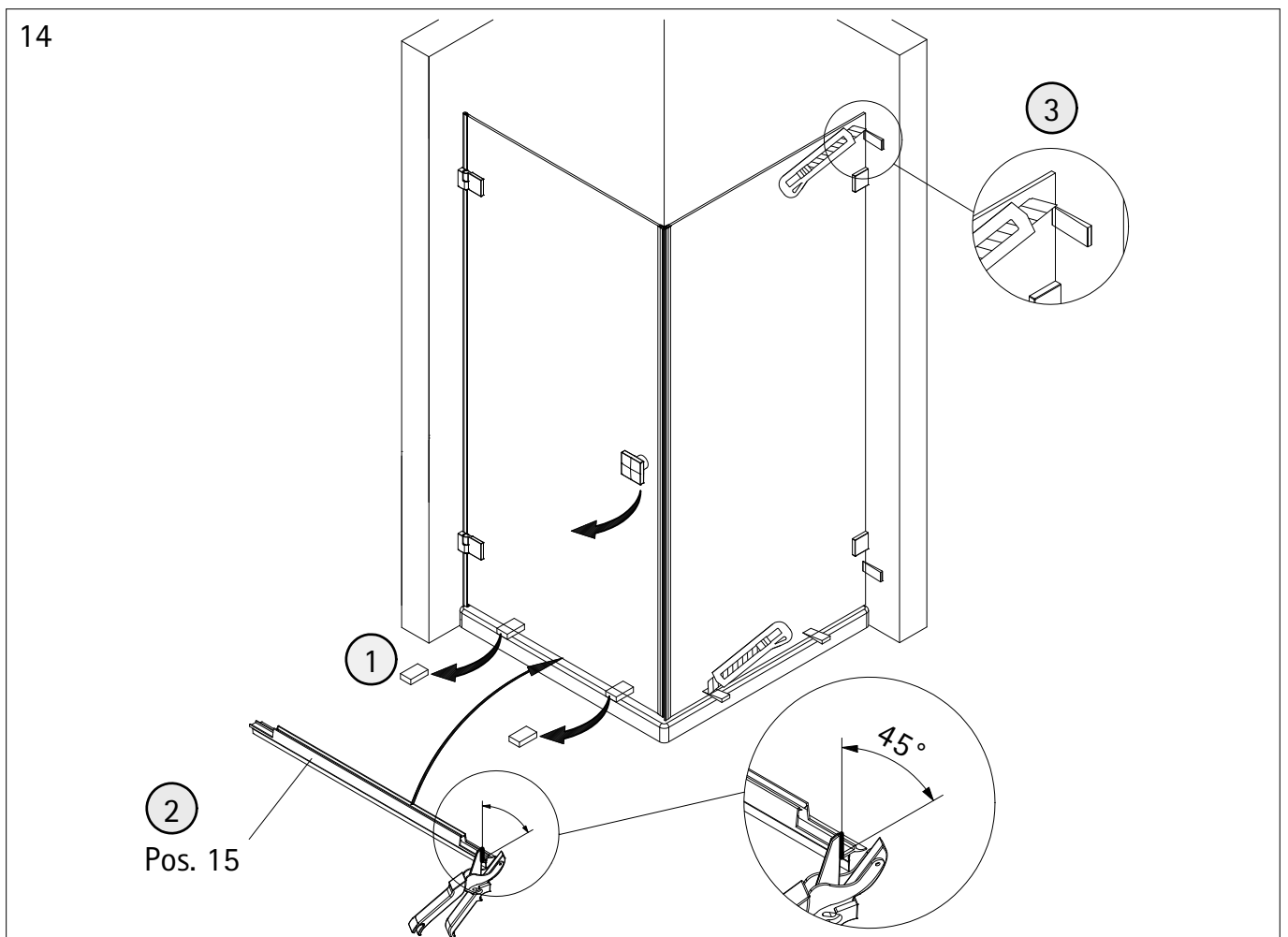
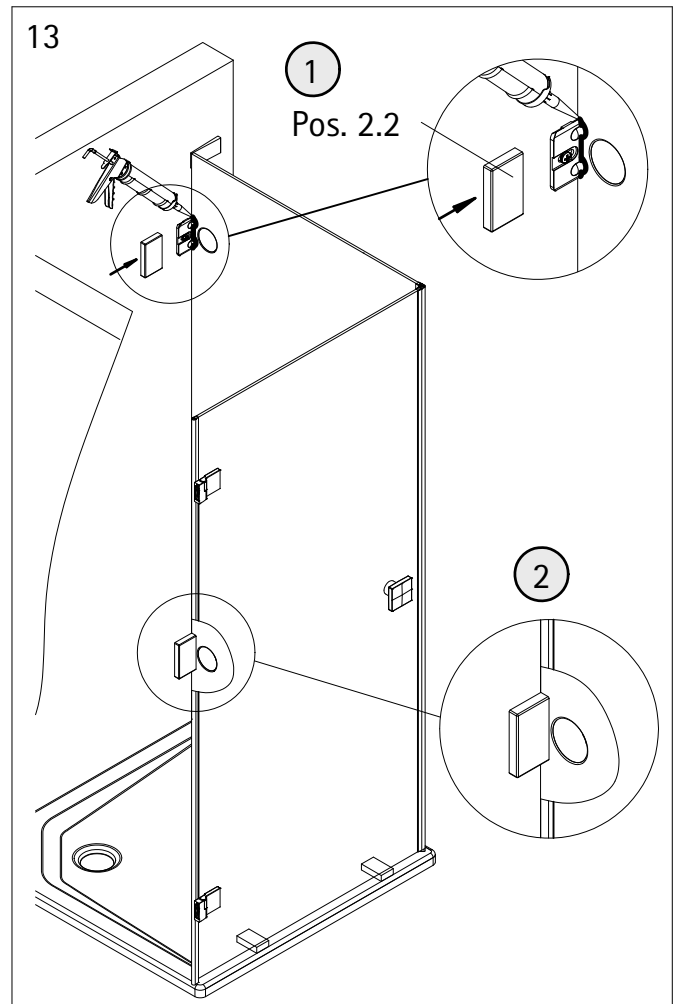
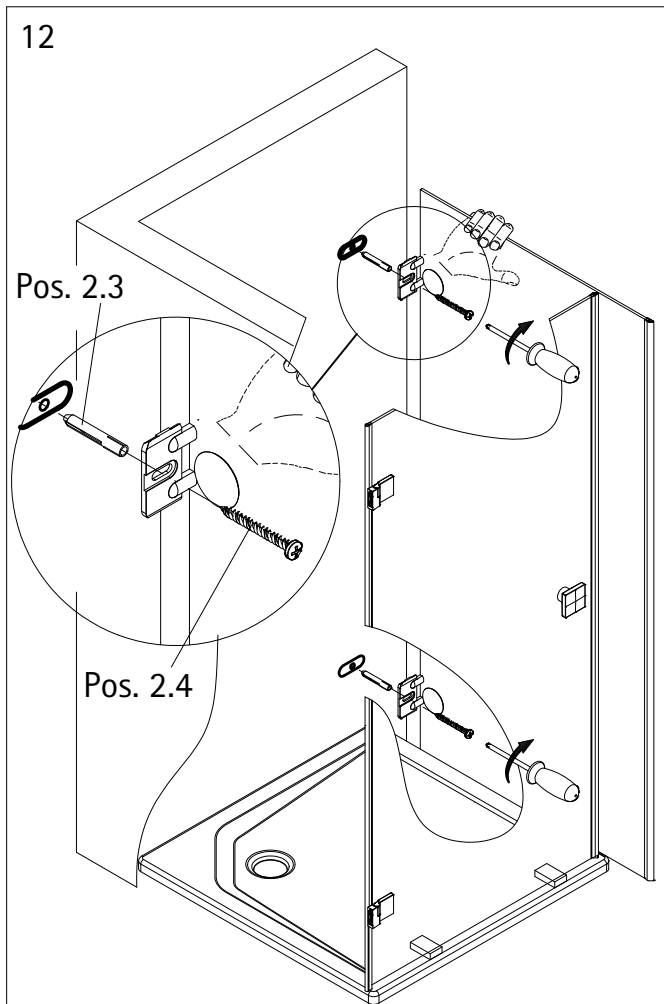

15

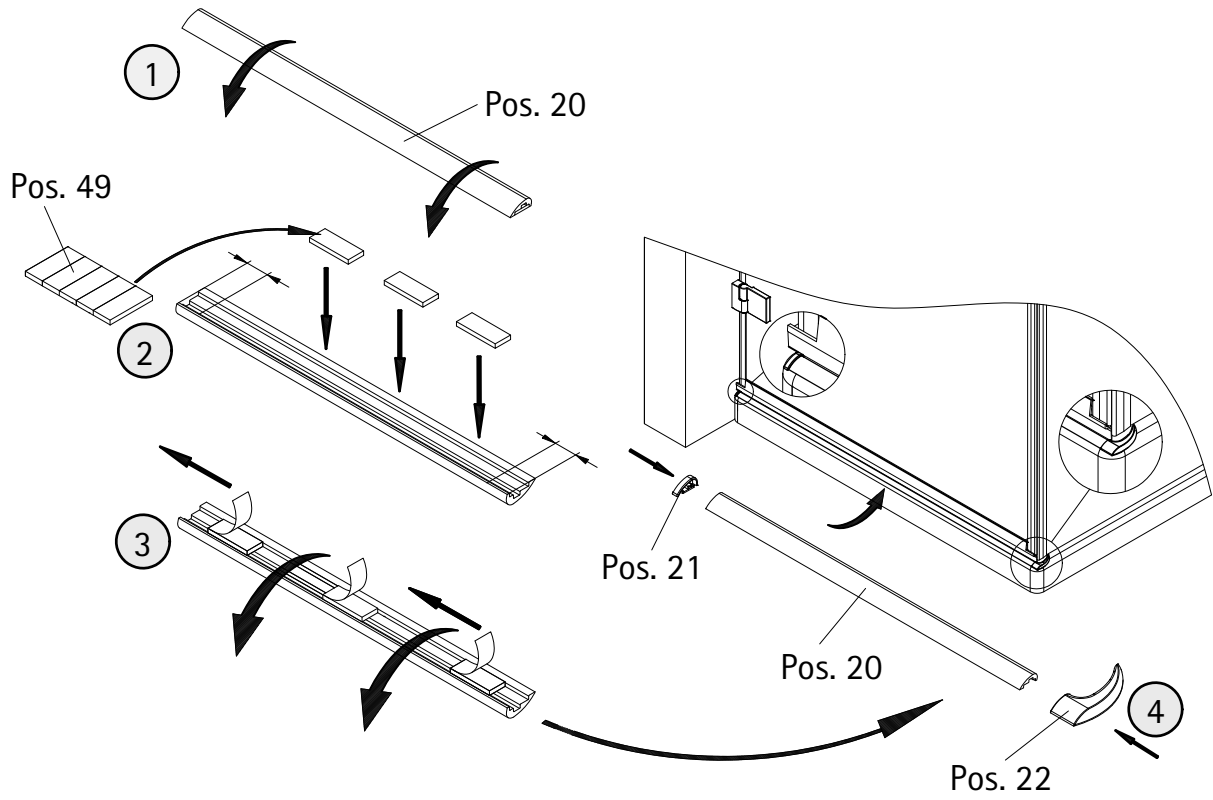

16

Wenn die Tür schließt, dann kann am Scharnier der Winkel der Tür verändert werden.

If the door doesn't close properly, the angle of the door can be adjusted at the hinge.

Quand la porte ne ferme pas on peut changer l'equerre de la porte avec l'aide de la charnière.

Als de deur niet sluit dan kann de hoek van de deur worden gewijzigd.

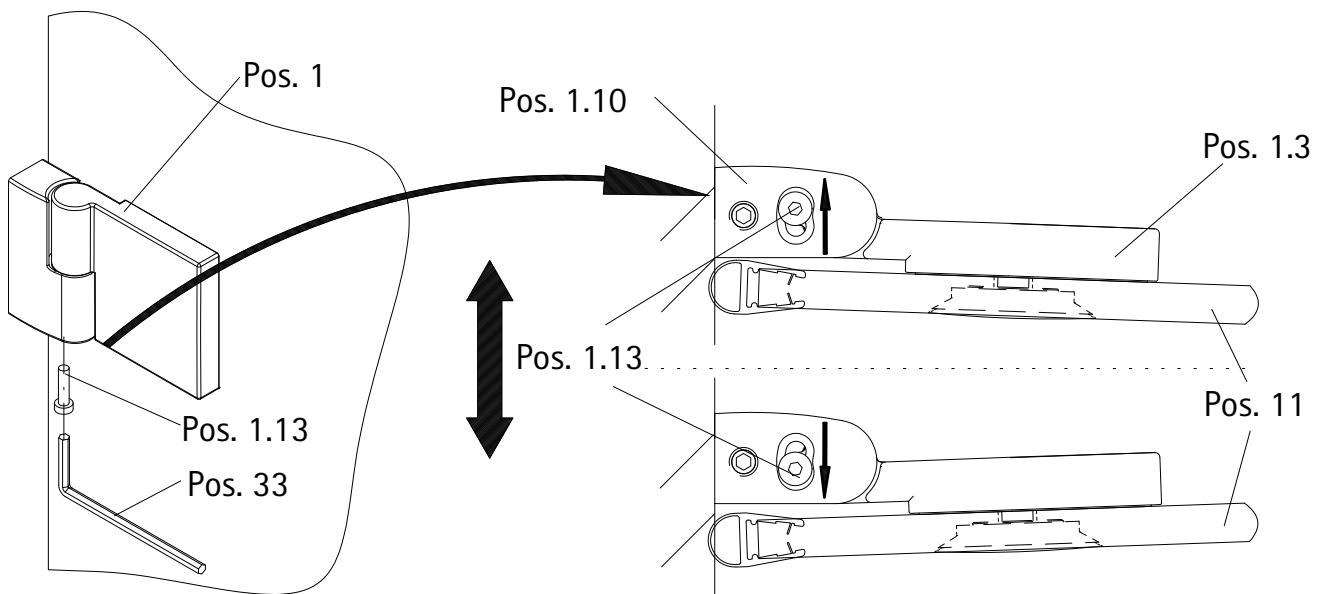
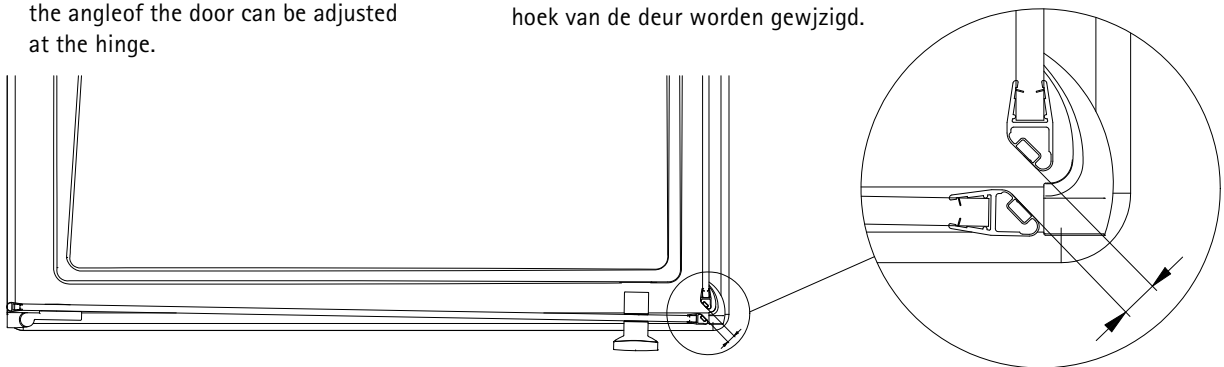

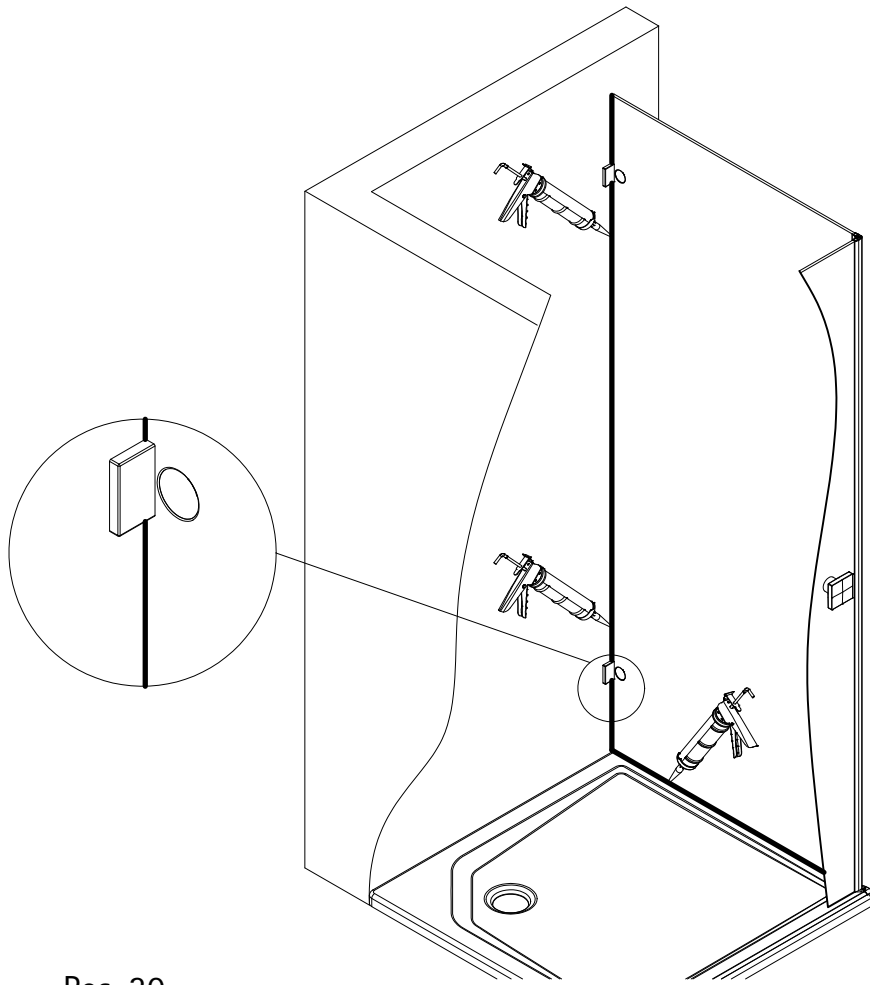

Pos. 30

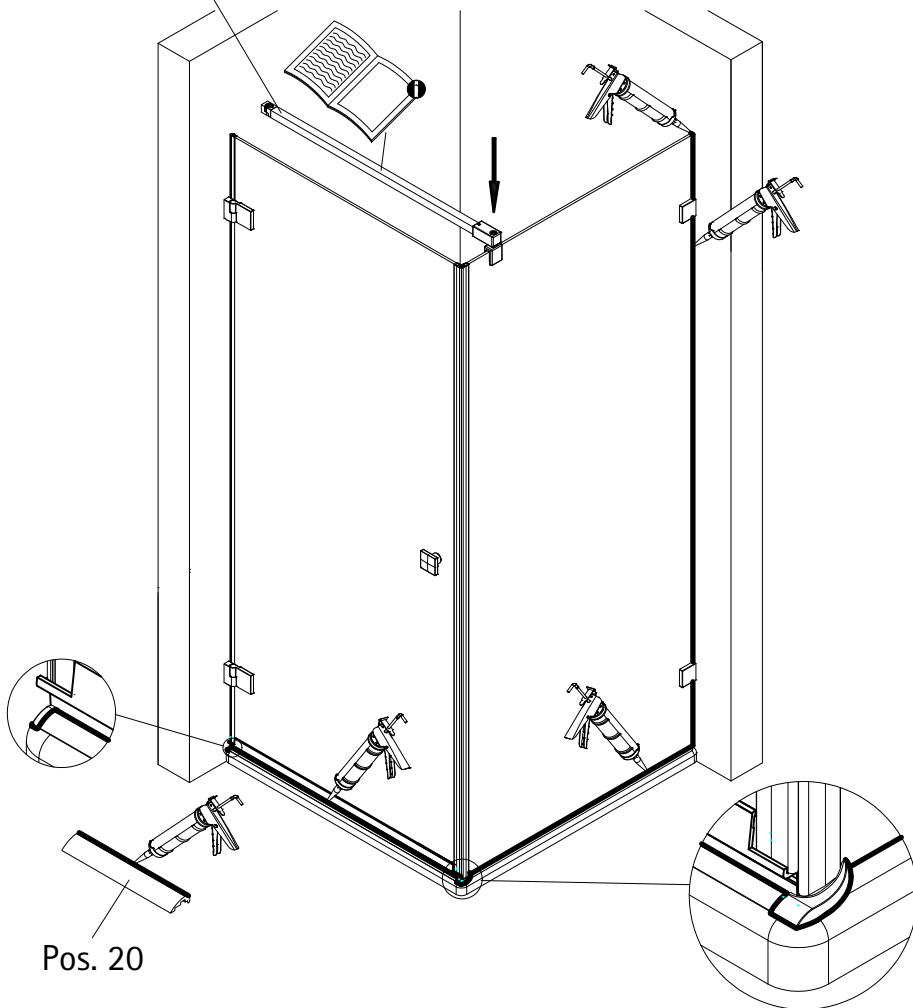

Pos. 20



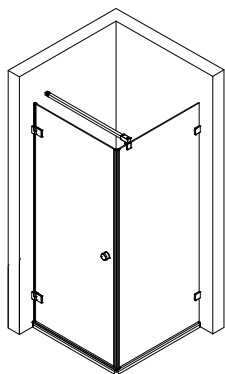

Kontrollbeleg Control Receipt

Prüfnummer / Inspection number



Duschservice
Zum Hohlen Morgen 22
59939 Olsberg
Deutschland / Germany / Allemagne / Duitsland



Ersatzteilbestellung:



Fax 02962 / 972-4260

Allgemeine technische Probleme:



Telefon 02962 / 972-40

E-mail:



ersatzteile@duschservice.de